

1. Welcome and Introduction

Welcome to the public exhibition on proposals to upgrade the Grange University Hospital Emergency Department

Welcome to this public exhibition on proposals to upgrade the Grange University Hospital Emergency Department.

Aneurin Bevan University Health Board is currently developing a strategy to improve patient experience of the existing Emergency Department facilities and waiting area, enabled by a proposed extension to the hospital building. Ahead of a formal planning application to Torfaen County Borough Council, this exhibition sets out further details of what is being proposed and includes an opportunity for you to provide your feedback.

The consultation will run from 12 June to 9 July 2023. Further details of how to respond can be found on the final board and at: <https://abuhb.nhs.wales/about-us/engagement-on-the-emergency-department-extension-the-grange-university-hospital/>. This link also contains draft copies of all planning application documents.

Your views are welcome!



2. The Emergency Department today

The Aneurin Bevan University Health Board is responsible for planning and delivering NHS services across Gwent, to a population of around 600,000 people. This includes GP, local and community health services; the Royal Gwent, Nevill Hall and Ysbyty Ystrad Fawr Local General Hospitals; and the Grange University Hospital Specialist and Critical Care Centre.

The Grange University Hospital opened in November 2020 as the designated Specialist and Critical Care Centre for Gwent and provides care for the most seriously ill patients or those with significant injuries who cannot be safely managed at a Local General Hospital. The hospital has 450 beds, and features a 24-hour Acute Assessment Unit, Emergency Department, and Helicopter Pad.

The existing Emergency Department is primarily intended to treat patients arriving via ambulance or helicopter, following a 999 call or transfer from another healthcare facility. Since opening the department has seen a greater-than-expected number of patients arriving by private car and higher attendance than forecast. This has led to instances of overcrowding within the Emergency Department, which currently has sufficient waiting space for 38 patients.

To improve patient and staff experience, the Health Board has identified the need to reconfigure and expand the Emergency Department in order to provide additional waiting spaces and assessment rooms.

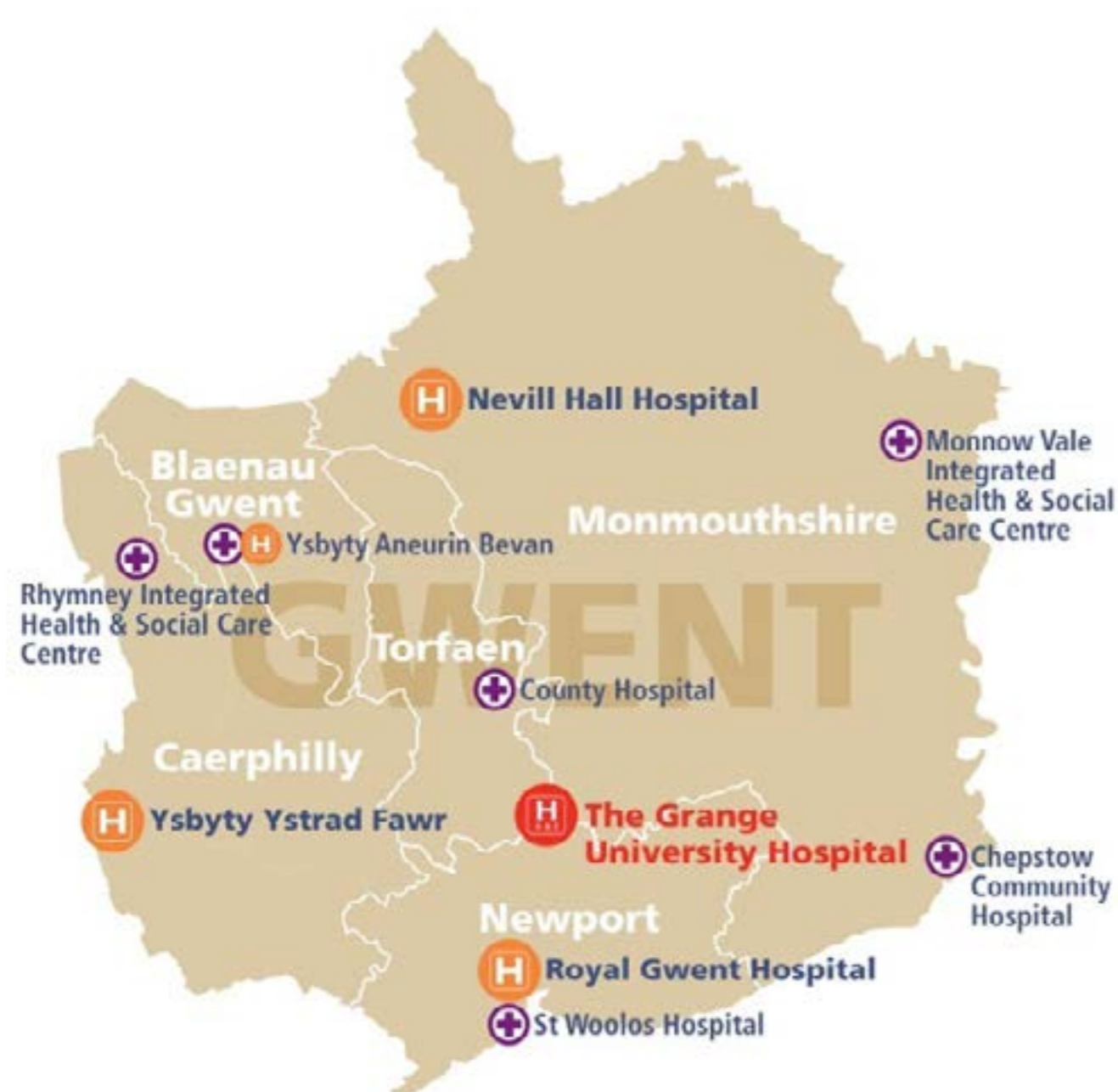

The proposals will address existing capacity issues and are not intended to result in an increased number of patients using the Emergency Department, or provide additional services. Patients should only attend the Emergency Department if they have a serious and life-threatening condition that needs urgent medical attention. The Health Board are encouraging people to consider alternative services if you become unwell. You can check your symptoms at <http://111.wales.nhs.uk> or for advice call NHS 111.

3. The Proposals



The proposals will upgrade the Emergency Department through provision of a new two storey entrance building which extends the main waiting room in order to create seating capacity for at least 78 patients and provide additional staff facilities.

In turn, these new spaces will enable wider reconfiguration of the department to provide an increase in assessment rooms, 6-10 'Fit to Sit' rooms for patients awaiting admission to hospital, and an additional ECG room to ensure that patients experiencing chest pain can be seen within appropriate timescales. The additional space will create a more purposeful, brighter and calmer environment for patients, and improvements will also be made to the provision of toilet facilities and signage.



4. Design

The extension will be smaller in scale than the main five-storey hospital building, and connect to the existing Emergency Department via a linking corridor between the two. The new building will be constructed from high quality materials which integrate with the existing hospital while ensuring that the building is clearly visible as a front door to the Emergency Department, aided by an entrance canopy and large format signage on its exterior.

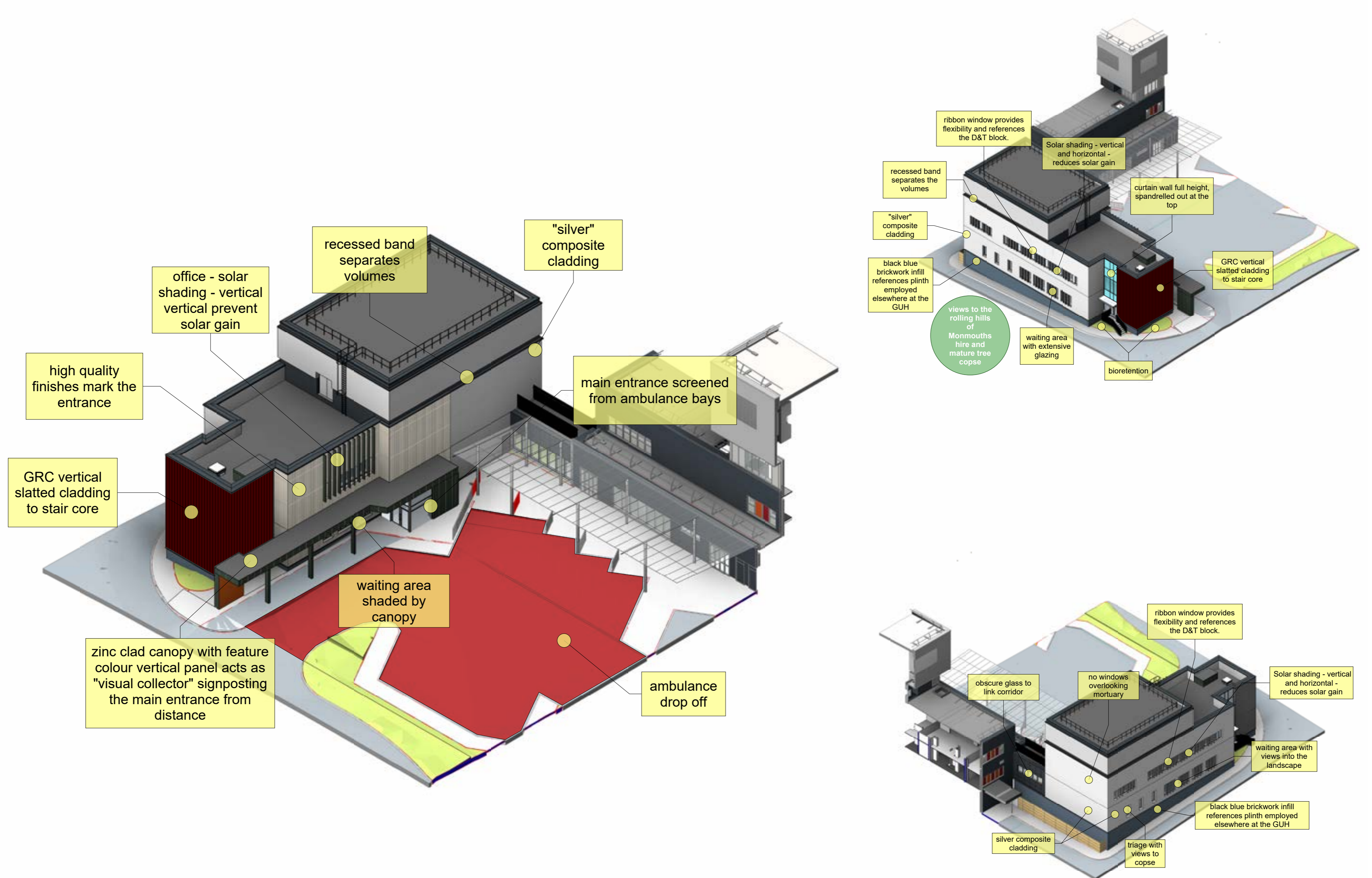

The colour palette used will reflect that of the main hospital entrance to the south of the site, providing two bookends to the hospital building. The incorporation of a higher proportion of glazing on the east facing façade takes full advantage of the hospital's landscape context, to provide long distance views across the Monmouthshire countryside.

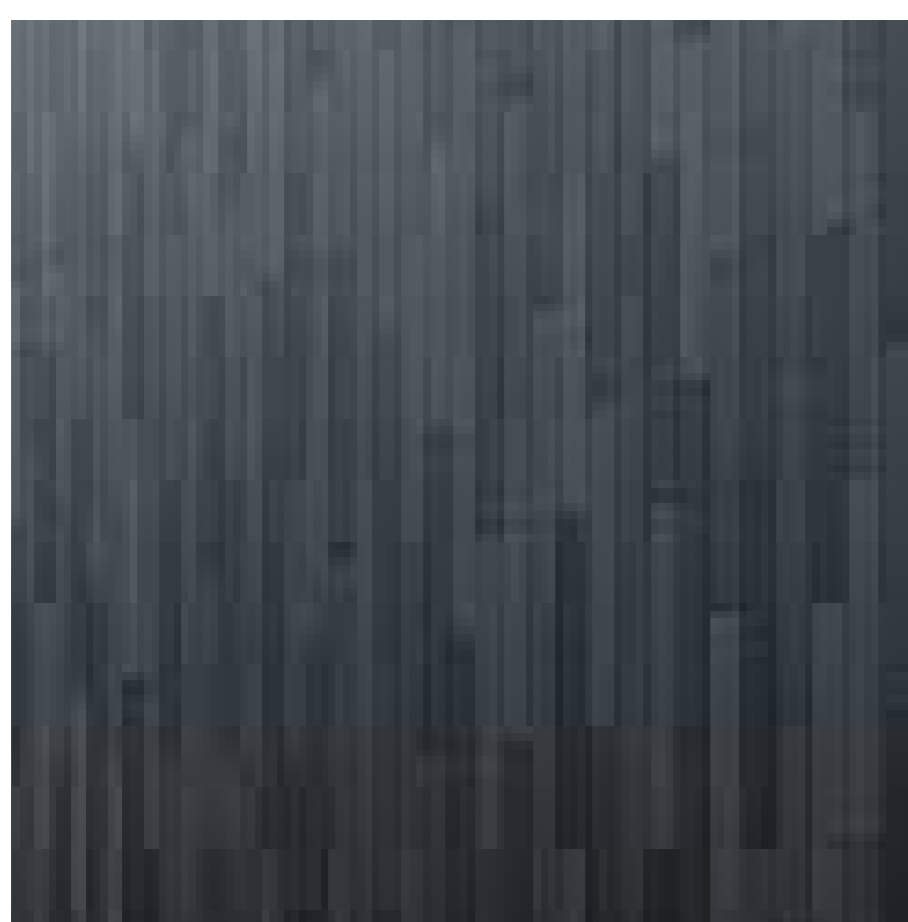

GRC Rainscreen Cladding



GRC Rainscreen Cladding



Staffordshire Blue Brick



Mineral wool core composite panel

5. Landscaping, Access and Sustainability

Landscaping

The proposals include high quality landscaping interventions, such as a new biodiverse seating area adjacent to the existing children's play area, and the introduction of a bioretention system to the north of the extension, to improve water quality and protect against flooding.

The planning application is supported by an ecological assessment report, which confirms that the existing site is unlikely to support any protected species, and recommends a series of precautionary measures to avoid adverse ecological

impacts during construction of the development.



Access

The extension will provide a new entrance to the Emergency Department for patients arriving by private car, and will be clearly signposted from a dedicated emergency arrival car park accessed separately to the hospital's main staff and visitor parking facilities. The route between the car park and entrance

has been devised in order to minimise conflicts with blue light vehicles.

The new facilities are intended to address existing demand for emergency care, and should not result in additional patient or staff trips to the hospital. Surveys of the surrounding road network have demonstrated that the current

operation of the hospital does not result in any unacceptable highways impacts, and this is expected to continue.

The proposals are also considering active travel and how people will access the Emergency Department on foot or bicycle.

Sustainability

The new building will be highly sustainable, and incorporate renewable energy generation through provision of solar panels on the roof of the existing ED department. This will be supported by the extension of building services from the existing hospital.

The development is on target to achieve a BREEAM "Very Good" sustainability score, in accordance with Torfaen County Borough Council's policy targets.

6. Have Your Say

Public consultation on the proposals is now open, from 12 June to 9 July 2023.

You can provide your comments by:

- Filling out an online questionnaire, at: <https://abuhb.nhs.wales/about-us/engagement-on-the-emergency-department-extension-the-grange-university-hospital/>
- Emailing: ABB.ABUHBplanningfeedback@wales.nhs.uk

Once the consultation has closed, the draft planning application will be updated in response to comments received before it is submitted to Torfaen Borough County Council for formal approval.

For further detail on the proposals, please visit <https://abuhb.nhs.wales/about-us/engagement-on-the-emergency-department-extension-the-grange-university-hospital/> where these consultation boards, and draft copies of all planning application documents, are available to download.

Once the application has been submitted you will be able to view the planning application and supporting documentation on Torfaen County Borough Council's planning register and provide your comments in response to the Council's formal statutory consultation, at the following link: <https://planningonline.torfaen.gov.uk/online-applications/>.

